

Tailor-made solutions for the aluminium industry.

Top quality refractory materials.



RATH

Specialist for top technology in high temperature.

**Quality with an optimum
price-performance ratio.**



Rath offers the ideal combination of tradition and innovation. The result: optimum refractory solutions for a wide range of applications. All items in our broad product portfolio are manufactured in-house. With carefully selected materials and precision processing techniques, we can guarantee top quality.

The Rath sales teams are focussed on the sector and familiar with its specific requirements; our technical offices provide the necessary engineering and assembly know-how. This means we can offer our customers individual, complete refractory solutions with an optimal price-performance ratio.

The Rath sales team

Greater efficiency in aluminium production.



Drum melting furnace

Our products guarantee energy savings and help protect the environment at a time of rising energy costs and increased environmental awareness. For the aluminium industry in particular, this is a decisive factor.

What is more, operators and plants must meet high quality and efficiency standards when it comes to manufacturing and recycling aluminium. With its clear and targeted focus on quality and innovative solutions, Rath is the ideal refractory solutions partner for the aluminium industry.



Always expect us to be one step ahead.

Aluminium is the most important of the non-ferrous metals. Despite its low melting point of just 660°C, it nevertheless requires production units to have high-performing refractory.

Rath supplies refractory material both for primary aluminium production – rotary furnaces for calcination, anode furnaces, electrolysis cells – and for the secondary aluminium industry.

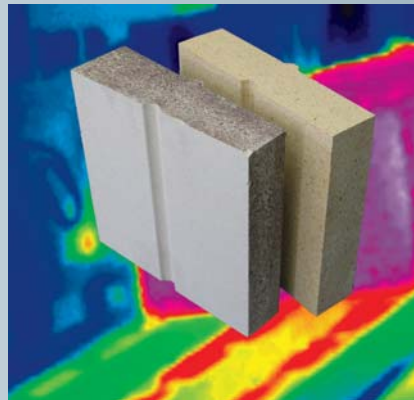

Dense bricks

Precision is the order of the day.

Rath has a number of engineering departments where working drawings are produced for refractory linings destined for a range of applications. The low viscosity of liquid aluminium or the aluminium melt means in-depth knowledge and great experience are required in construction.

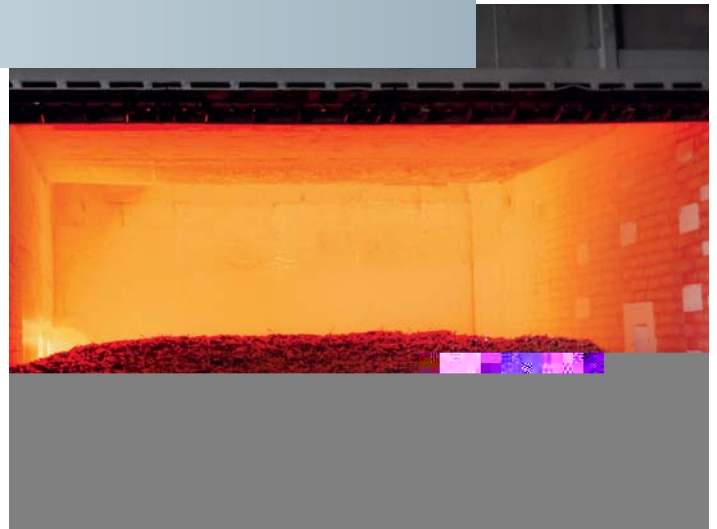

Aluminium melting furnace

Refractory solutions in all shapes and forms. Just ask.

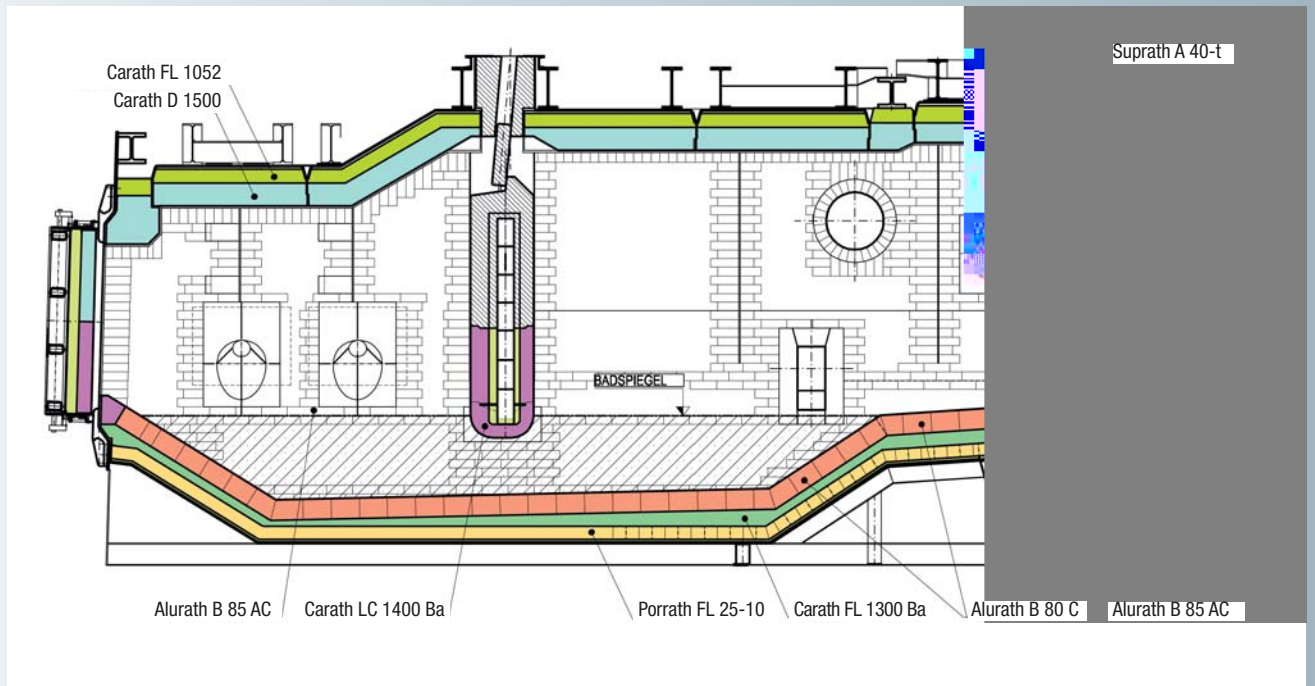

Longitudinal section of a double chamber furnace

We're burning to solve your problems.



Double chamber melting furnace



Tilting furnace

The equipment for melting materials and main-taining temperatures in re-melting furnaces and in foundries – hearth furnaces, single and double chamber furnaces, shaft kilns and induction furnaces – is lined with bauxite bricks and refractory castables (barium sulphate admixture) which are resistant to molten aluminium.

Highly resilient bauxite bricks have already proved highly effective and resilient in sections of ramps and bridges subject to extreme mechanical strain.

Nearly all our refractory castables are cast in just about every conceivable geometric form in one of the most modern production plants for pre-fabricated castable components. These can be tempered, depending on their eventual application or also pre-fired at up to 1750°C: this means they can also be supplied vitrified.

These products have a range of applications in the aluminium industry, for example as channels, burner blocks, pouring blocks, pump blocks for electric melt pumps, pre-cast shapes or ladle lining.

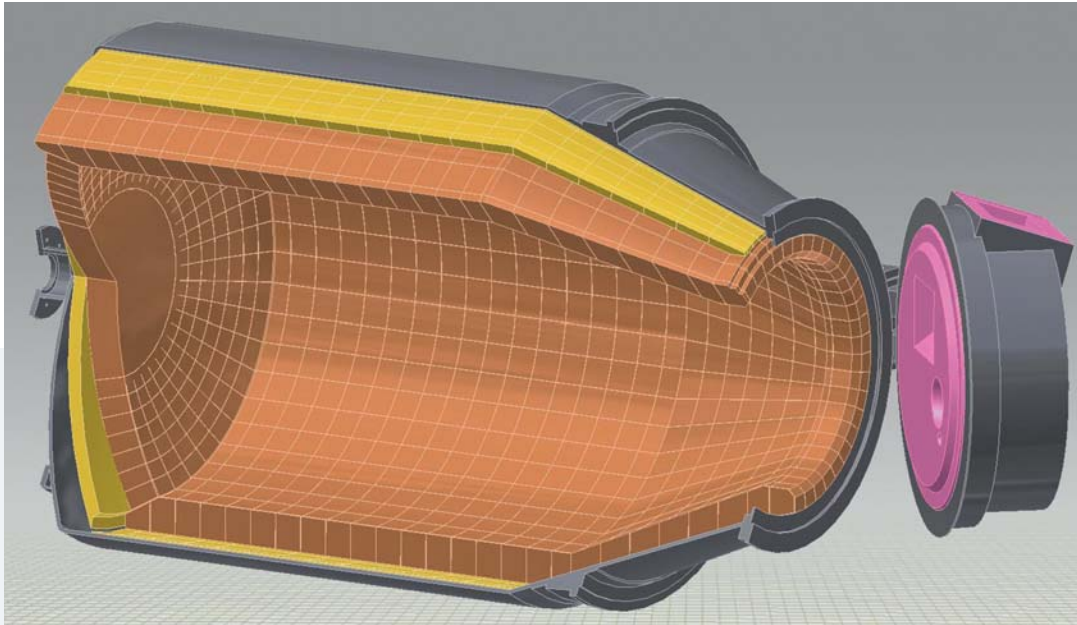

Cross-section of a rotary drum furnace

We're happy if things really start to hot up.

Rotary drum furnaces and tilting melting furnaces need to be lined with wear-resistant refractory material. This is where extremely dense fireclay bricks, silimanite bricks or bauxite bricks with a chemical are used.



Bricks

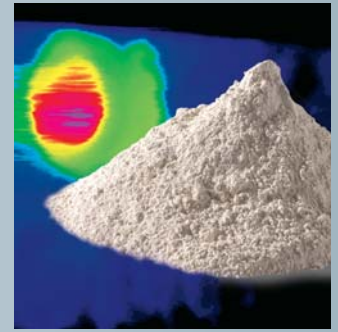

Masses

Bricks

Name	Suprath A 40-t	Suprath T 45	Durrath HS-e	Silrath AK 60	Silrath AK 45 SiC 15	Alurath B 85 AC *	Alurath B 80 C
Raw material	Fireclay	Fireclay with high mullite content	Low-ferrous fireclay	Andalusite	Andalusite	Bauxite	Bauxite
Bulk density [g/cm ³]	2.35	2.3	2.35	2.6	2,6	2.9	2.85
Cold crushing strength [MPa]	≥ 60	≥ 40	90	100	100	> 80	200
Porosity [Vol.-%]	≤ 15	≤ 14	≤ 14	≤ 13	11	≤ 18	12
Thermal shock resistance [n]	18	≥ 30	> 30	120	120	50	≥ 25
Chemical analysis Al ₂ O ₃ [%]	≥ 42	46	47	61	45	78	83

* phobic towards aluminium

Unshaped refractories

	Dense castables	Low-cement castables		Gunning castables		Insulating refractory castables			Plastic masses
Name	Carath® D 1500	Carath® LC 1200 Ba*	Carath® LC 1400 Ba*	Carathgun D 1400 Ba*	Carathgun D 1501	Carath® FL 1052	Carath® FL 1300 Ba*	Carath® FL 1401	Carathplast 850 Ba*
Raw material	Fireclay with high mullite content	Bauxite	Corundum	Corundum	Andalusite	Perlite	Lightweight-fireclay	Lightweight-fireclay	Fireclay, barite
Material required [kg/m ³]	2250	2860	2960	2500	2260	650	1500	1400	2100
Cold crushing strength [MPa]	60	120	75	50	35	1.2	19	25	8
Service temperature [°C]	1500	1200	1400	1400	1500	1050	1300	1400	850
Chemical analysis Al ₂ O ₃ [%]	54	78	84	80	60	> 40	42	45	≤ 25

* phobic towards aluminium

International top



Pouring block

Casting furnace High temperature wool

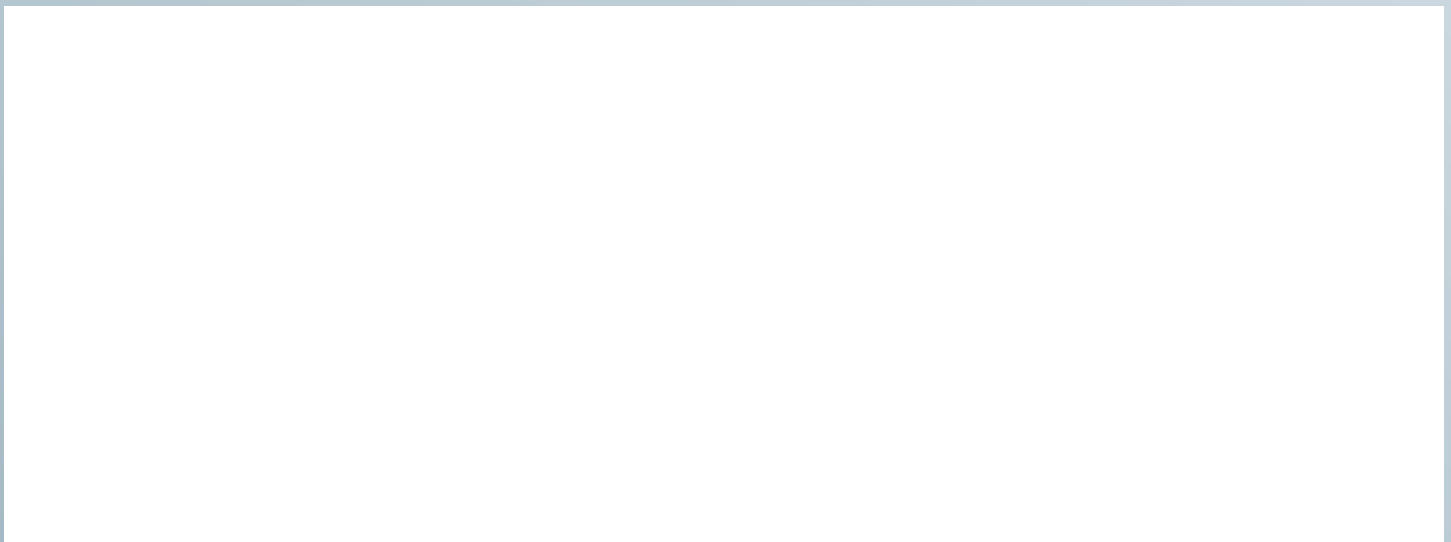

Production in our own factories.

There is one very special feature of Rath: we can always fully guarantee the quality of our highly refractory products, as we manufacture them all ourselves.

State-of-the-art production processes are used in our plants in Europe and the USA. We constantly adapt these processes in line with technical and technological developments as we strive to provide you with top quality.

Our approach benefits our customers: high quality products ensure operational safety and reliability over a long period of time. This means less repairs, less breaks in production and lower costs.



Krummnußbaum



Milledgeville

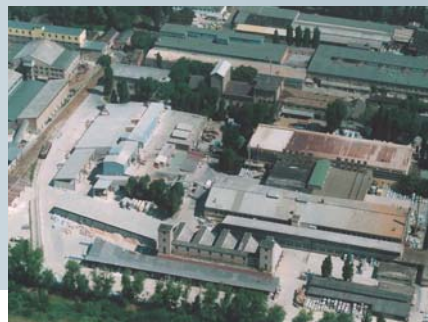

Budapest

Rath meets all ISO criteria.

Quality in production can be measured – with ISO 9001/9002. All companies in the Rath Group are certified according to the strict criteria for this standard. We are doing everything to build constantly on this quality standard.

Our products undergo rigorous testing in our own company laboratories. We also regularly have externally government-authorized recognised test centres check material characteristics.

Our customers can rest assured that all our products are up to date – and provide, in practice, everything that we have promised.

The Rath Group.

Our sales subsidiaries worldwide.

Aug Rath jun. GmbH

Walfischgasse 14
A-1015 Vienna
Tel. +43 (1) 513 44 26-0
Fax +43 (1) 513 44 26-86

Rath GmbH

Ossietzkystraße 37/38
D-01662 Meißen
Tel. +49 (35 21) 46 45-0
Fax +49 (35 21) 46 45-86

Rath GmbH

Krefelder Straße 680-682
D-41066 Mönchengladbach
Tel. +49 (21 61) 96 92-0
Fax +49 (21 61) 96 92-61

Rath Hungaria Kft.

Porcelán utca 1
H-1106 Budapest
Tel. +36 (1) 43 300 43
Fax +36 (1) 26 1 90 52

Rath Ukrajina TOW

Prospekt Osvoboshdenije Donbassa 8b
Office 206
UA-83048 Donezk
Tel. +380 (62) 345 33 06
Fax +380 (62) 345 63 26

Rath USA Inc.

300 Ruthar Drive Suite 1
Newark, DE 19711
Tel. +1 (302) 294 4446
Fax +1 (302) 294 4451

Rath žárotechnika spol. s r.o.

Vorlesská 290
CZ-544 01 Dvůr Králové n. L.
Tel. +420 (499) 321 577
Fax +420 (499) 321 003

Rath Polska Sp. z o.o.

ul. Fabryczna 1
PL-42 530 Dąbrowa Górnicza
Tel. +48 (32) 268 47 01
Fax +48 (32) 268 47 02

Rath SAS

60, route principale du Port
F-92637 Gennevilliers-Cedex
Tel. +43 (1) 513 44 26-0
Fax +43 (1) 513-44 26-86

Rath AG per l'Italia

Im Helui 15
I-39030 Chienes (BZ)
Tel. +39 (0474) 56 56 20
Fax +39 (0474) 56 56 28

E-Mail: info@rath-group.com
Internet: www.rath-group.com